

EXAMPLE: B30

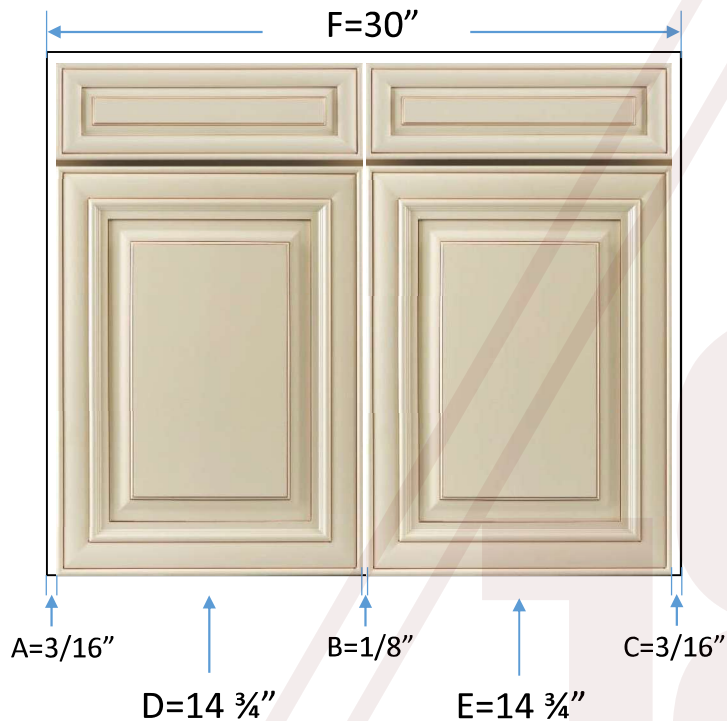

EXAMPLE: B15



The Nominal Width of B15 base cabinet is supposedly 15". But in fact, its Actual Width is 15" plus 1/8" (G). This is due to the fact that, the space between the single door side edge and the frame edge (A and C) must each equal to 3/16" in B15, which must also match with the same space (A and C) in B30; and with the actual Width of the single door itself being 14 3/4" (D and E), all these make the total Width of B15 having 1/8" extra. This extra 1/8" in total Width of B15 may also be understood as being transferred from the opening space of 1/8" (B) between the two doors in B30.

\*This applies to all single doored cabinets(except 9" cabinets) and all door styles.

C A B I N E T R Y